

PERFORMANCE STRUTS

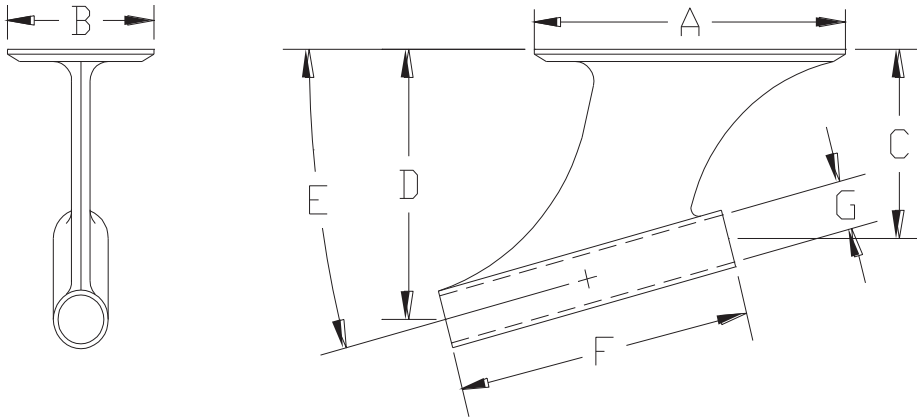

PERFORMANCE STRUTS

MA PART	A	B	C	D	E	F	G	WEIGHT
2-02102-E	7 1/2	3 1/2	4 7/8	6 1/8	16 D	8 1/8	1 1/4	7.9
2-02103-G	8	3 1/2	6 5/16	7	12 D	8	1 1/2	
2-02106-G	6	3 1/8	5 9/16	7 5/16	16 D	6 3/8	1 1/2	
2-02242-G	8	4	5 3/8	7 3/8	14 1/2 D	7 3/4	1 1/2	10.1
2-02352-G	8 5/8	4			15 D	7 7/8	1 1/2	9.75
2-02362-E	8 1/2	4	4 1/8	6 3/16	15 D	8	1 1/4	7.6
2-02372-G	8 1/2	4	4 1/8	6 3/16	15 D	8	1 1/2	8.1
2-02392-E	8 1/2	4	4 3/4	7	16 D	8	1 1/4	7.65
2-02402-G	8 1/2	4	4 3/4	7	16 D	8	1 1/2	7.9
2-02612-E	6	4	5 1/2	7 1/8	16 D	6	1 1/2	11.5
2-02622-G	6	4	7 3/4	9 5/16	15 D	6	1 1/2	13
2-02682-E	6	3 1/8	5 9/16	7 5/16	16 D	6 3/8	1 1/2	7.86
2-02682-F	6	3 1/8	5 9/16	7 5/16	16 D	6 3/8	1 3/8	7.86
2-02842-E	6	3 1/8	5 1/2	7 5/16	16 D	6 3/8	1 1/4	
2-02842-G	6	3 1/8			16 D	6 3/8	1 1/2	